



Kempsters
ESTATE AGENTS

38 Argent Court Argent Street
Grays RM17 6QT



Guide price
£185,000

GUIDE PRICE £185,000 - £190,000.

This outstanding one double bedroom 2nd floor apartment with lift is situated in a popular location within easy walking distance of Grays centre. Includes a spacious open plan lounge/fitted kitchen, large bedroom, stylish bathroom, communal gardens and allocated parking via electric security gate. 360 TOUR AVAILABLE



- Electric heating
- Double glazing
- Open plan lounge/kitchen 28'10 x 13'4>8'7
- Bedroom 15'6 x 10'1
- Stylish bathroom
- Communal gardens
- Allocated parking space

ENTRANCE

Door to:

ENTRANCE HALL

Coved and smooth plastered ceiling, built-in storage cupboard, entry phone, wall mounted electric heater, power point, laminate floor.

OPEN PLAN LOUNGE/KITCHEN

28'10" x 13' narrowing to 8'7" (8.79m x 3.96m narrowing to 2.62m)

Lounge area: Double glazed French doors with matching side windows and Juliette balcony overlook the communal gardens, coved and smooth plastered ceiling, wall mounted electric heater, power points, fitted carpet. Open plan to kitchen area: smooth plastered ceiling, range of base and eye level units with contrasting work surfaces, inset single drainer sink unit, integrated oven, hob and canopy with extractor, space for fridge/freezer, space and plumbing for washing machine, partly tiled walls, power points, vinyl floor covering.

BEDROOM

15'6" x 10'1" (4.72m x 3.07m)

Double glazed window overlooking communal gardens, smooth plastered ceiling, wall mounted electric heater, power points, fitted carpet.

BATHROOM

Smooth plastered ceiling, extractor fan, suite comprising bath with mixer tap and shower attachment, vanity unit with inset wash hand basin and low flush wc, full tiling to bath area, further wall partly tiled, heated towel rail, vinyl floor covering.

EXTERIOR

Well tended communal gardens, allocated parking space.

LEASE DETAILS AND SERVICE CHARGES

Approximately 110 years remaining on lease

Ground rent/service charges: Approx £100 per month











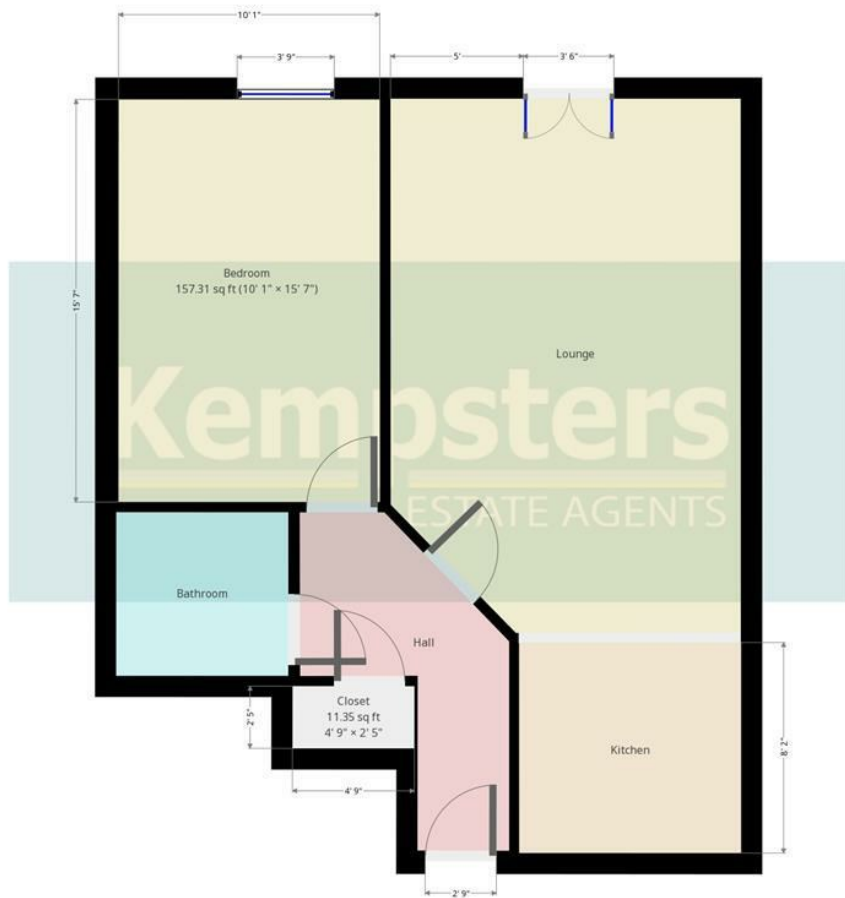

Kempsters Estate Agents take no responsibility for any error, omission, misstatement or use of data shown. This plan is for illustrative purposes only and whilst every attempt has been made to ensure the accuracy of the floorplan shown, all measurements, positioning, fixtures, fittings and any other data shown are an approximate...

Disclaimer: This brochure is for illustrative purposes only and, whilst every attempt has been made to ensure accuracy. Kempsters Estate Agents Ltd take no responsibility for any error, omission, mis-statement or use of any of the information shown. No appliances or main services have been checked.

37 Orsett Road Grays, Essex RM17 5DS • Tel: 01375 394 732 • Email: sales@kempsters.com

