



Kempsters
ESTATE AGENTS

5 Rosedale Road
Little Thurrock Grays RM17 6AD

3 1 1

Asking price
£230,000

This three bedroom house is situated in the 'ever popular ' Little Thurrock location and lies within walking distance of Grays town centre plus local shops and schools. The property requires modernisation throughout and is offered with no onward chain. 360 VIRTUAL TOUR AVAILABLE.



- Lounge 12' x 11'9
- Dining room 12' x 10'
- Kitchen 9'10 x 6'9
- Ground floor bathroom
- Bedroom one 12' x 10'
- Bedroom two 10' x 9'1
- Bedroom three 13'7 x 6'10
- South facing rear garden approx 40'
- Garage
- No onward chain

ENTRANCE

Opaque double glazed door leads to:

LOUNGE

12' x 11'9 (3.66m' x 3.35m'2.74m)

Double glazed window to front, power points, carpet.

INNER LOBBY

Built-in under stairs storage cupboard, carpet.

DINING ROOM

12' x 10' (3.66m' x 3.05m')

Double glazed window to rear, tiled fireplace, power points.

KITCHEN

9'10 x 6'9 (2.74m'3.05m x 1.83m'2.74m)

Double glazed window to side, Fitted cupboards with inset single drainer sink unit, ample appliance spaces, power points, vinyl floor covering.

SECOND INNER LOBBY

Half opaque double glazed door to side, large built-in storage cupboard, vinyl floor covering.

BATHROOM

Opaque double glazed window to rear, suite comprising bath with mixer tap and shower attachment, pedestal wash hand basin and low flush toilet, partly tiled walls, vinyl floor covering.

FIRST FLOOR LANDING

Access to loft space, power points.

BEDROOM ONE

12' x 10' (3.66m' x 3.05m')

Double glazed window to front, two built-in cupboards, power points, carpet.

BEDROOM TWO

10' x 9'1 (3.05m' x 2.74m'0.30m)

Double glazed window to rear, built-in cupboard, power points, carpet.



BEDROOM THREE

13'7 x 6'10 (3.96m'2.13m x 1.83m'3.05m)

Double glazed window to rear, vinyl floor covering.

SUNNY SOUTH FACING REAR GARDEN

in excess of 40' (in excess of 12.19m')

Small lawn area, personal door to:

GARAGE

Approached via rear vehicular access.

FRONT GARDEN

With wall surround.





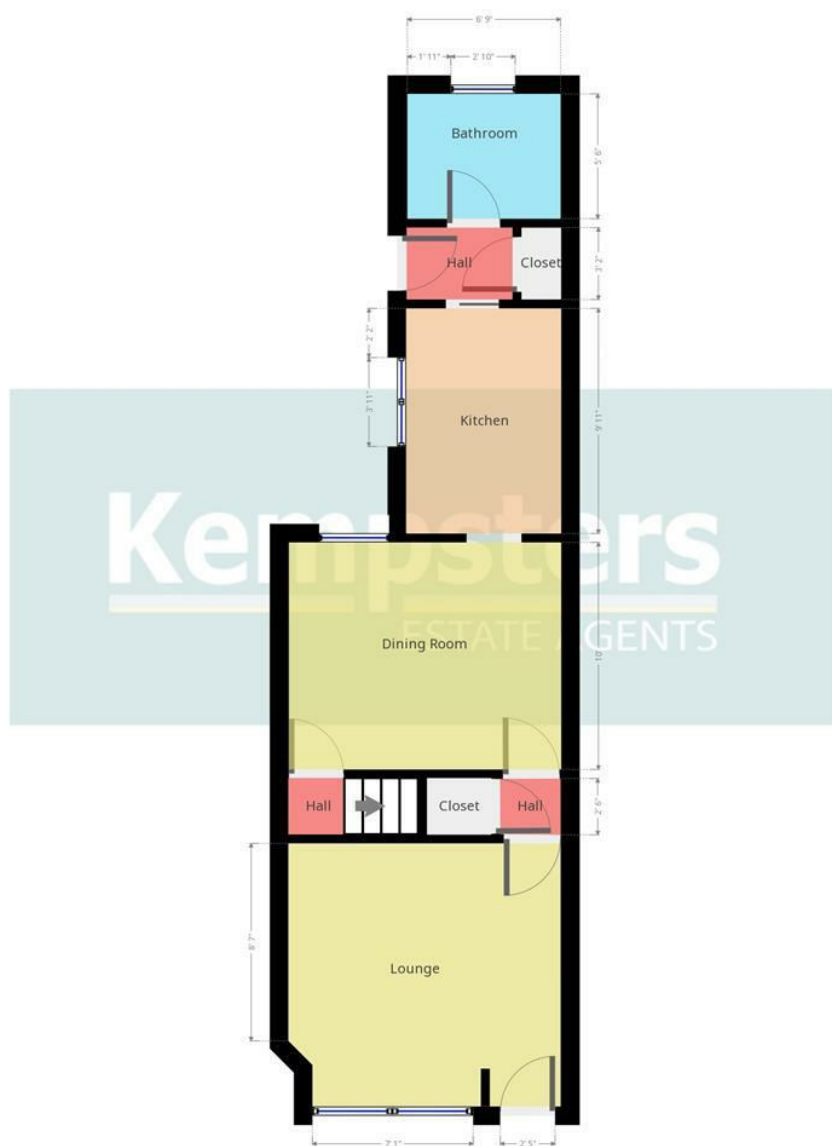

Kempsters Estate Agents take no responsibility for any error, omission, misstatement or use of data shown.
This plan is for illustrative purposes only and whilst every attempt has been made to ensure the accuracy of the floorplan shown, all measurements, positioning, fixtures, fittings and any other data shown are an approximate ...

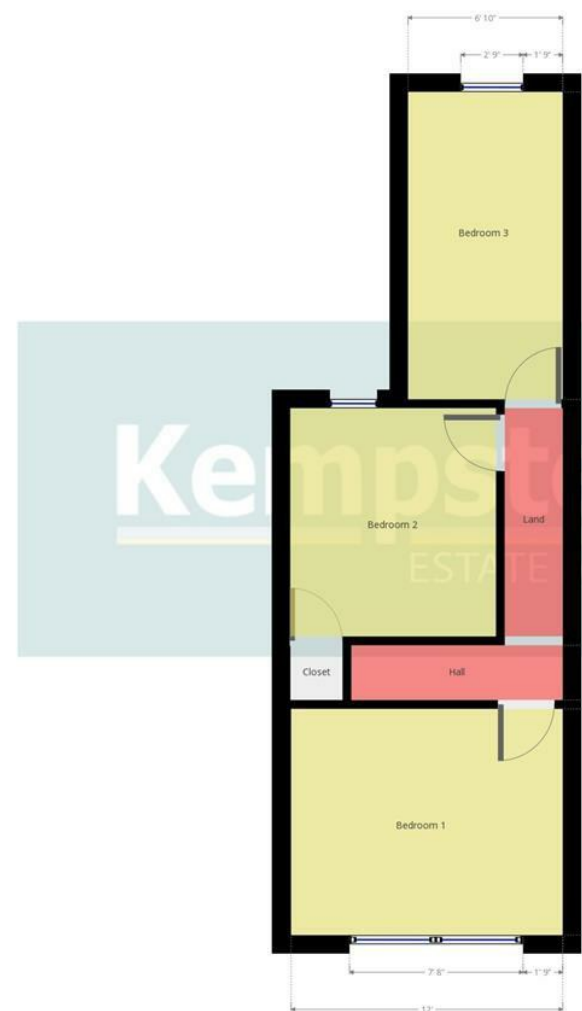

Kempsters Estate Agents take no responsibility for any error, omission, misstatement or use of data shown.
This plan is for illustrative purposes only and whilst every attempt has been made to ensure the accuracy of the floorplan shown, all measurements, positioning, fixtures, fittings and any other data shown are an approximate ...

Disclaimer: This brochure is for illustrative purposes only and, whilst every attempt has been made to ensure accuracy.
Kempsters Estate Agents Ltd take no responsibility for any error, omission, mis-statement or use of any of the information shown.
No appliances or main services have been checked.

37 Orsett Road Grays, Essex RM17 5DS • Tel: 01375 394 732 • Email: sales@kempsters.com

