



Kempsters
ESTATE AGENTS

81a Clarence Road
Grays RM17 6RA



Asking price
£150,000

This one bedroomed first floor flat is situated within a few moments walk of Grays town centre and is offered with no onward chain. Features include gas central heating, double glazing, lounge, kitchen, shower room, parking space plus 158 year lease.



- Gas Central Heating (untested)
- Double Glazing
- Lounge 13'5 x 10'11
- Kitchen 8'8 x 6'7
- Bedroom 11' x 10'4
- Shower Room
- Parking Space
- No Onward Chain
- Long Lease



ENTRANCE

Partially opaque double glazed door leads to:

KITCHEN

8'6 x 6'7 (2.44m'1.83m x 1.83m'2.13m)

Opaque double glazed window to side, coved and textured ceiling, base and eye level units with contrasting work surfaces, inset single drainer sink unit, space for gas cooker and fridge/freezer, power points, vinyl flooring.

SHOWER ROOM

Opaque double glazed window to rear, textured ceiling, suite comprising shower cubicle, wash hand basin and low flush toilet, recess with wall mounted gas central heating boiler and space for washing machine, radiator, partly tiled walls, vinyl flooring.

INNER HALLWAY

Coved and textured ceiling, access to loft space, radiator, power points, laminate floor.

BEDROOM

11' x 10'4 (3.35m' x 3.05m'1.22m)

Double glazed window to rear, coved and textured ceiling, radiator, power points, laminate floor.

LOUNGE

13'5 x 10'11 (3.96m'1.52m x 3.05m'3.35m)

Double glazed window to front, coved and textured ceiling, radiator, power points, laminate floor.

EXTERIOR

Parking space in bay below.

LEASE DETAILS AND GROUND RENT

Approximately 158 years remaining on lease.

Ground Rent: Nil











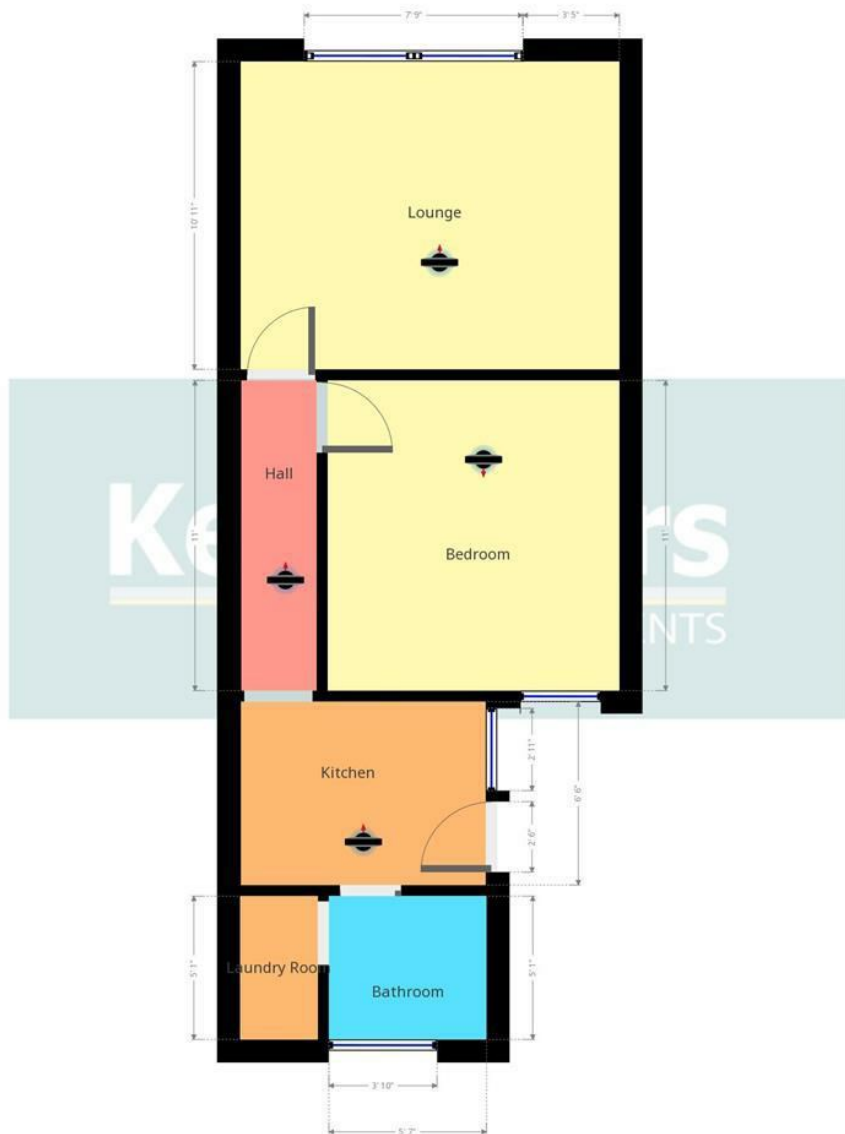

Kempsters Estate Agents take no responsibility for any error, omission, misstatement or use of data shown.
This plan is for illustrative purposes only and whilst every attempt has been made to ensure the accuracy of the floorplan shown, all measurements, positioning, fixtures, fittings and any other data shown are an approximate...

Disclaimer: This brochure is for illustrative purposes only and, whilst every attempt has been made to ensure accuracy. Kempsters Estate Agents Ltd take no responsibility for any error, omission, mis-statement or use of any of the information shown. No appliances or main services have been checked.

37 Orsett Road Grays, Essex RM17 5DS • Tel: 01375 394 732 • Email: sales@kempsters.com

