



**Kempsters**

**Kempsters**  
ESTATE AGENTS

16 Palmers Avenue  
Grays RM17 5UB

 3  1  2

Asking price  
**£525,000**



**This spacious and attractive three bedroomed detached character house is situated in a convenient and popular location within easy walking distance of Grays town centre. The property requires a large degree of modernisation throughout and is offered with no onward chain.**



- Modernisation Required
- No Onward Chain
- Lounge/Diner 30'10 max x 11'11
- Sitting Room 14' x 12'6
- Kitchen/Breakfast Room 18'7 x 12'6>6'11
- Bedroom One 18'3 x 12'6
- Bedroom Two 14'5<21'1 x 11'7
- Bedroom Three 14'2 max x 12'
- Sunny South Facing Rear Garden in excess of 110'
- Off Road Parking For Two/Three Vehicles





## **SMALL ENTRANCE PORCH**

Door to:

## **ENTRANCE HALL**

Double glazed window to side, access to first floor, under stairs storage cupboard, radiator, carpet.

## **GROUND FLOOR CLOAKROOM**

Opaque double glazed window to side, suite comprising wash hand basin and low flush toilet, tiled walls. Carpet.

## **SITTING ROOM**

14'1 x 12'6 (4.29m x 3.81m)

Double glazed bay window to front, coved ceiling, picture rail, radiator, power points, carpet.

## **LOUNGE/DINER**

30'10 max x 11'11 (9.40m max x 3.63m)

Double glazed half bay window to front, two opaque glazed arch windows to side, double glazed French doors lead to rear garden, two radiators, power points, carpet.

## **KITCHEN/BREAKFAST ROOM**

18'7 x 12'6 reducing to 6'11 (5.66m x 3.81m reducing to 2.11m)

Double glazed window to side, double glazed window and double glazed door lead to rear garden, coved ceiling, base and eye level units with rolled edge work surfaces, inset single drainer sink unit, integrated oven, hob and extractor, ample appliance spaces, wall mounted gas central heating boiler, radiator, power points, vinyl flooring.

## **FIRST FLOOR LANDING**

Double glazed window, to side, coved ceiling, built-in airing cupboard, power points, carpet.



## **BEDROOM ONE**

18'3 x 12'6 (5.56m x 3.81m)

Opaque double glazed window to side, double glazed window to rear, coved ceiling, access to loft space, fitted shower cubicle, range of fitted wardrobes with matching chest of drawer unit, radiator, power points, carpet.

## **BEDROOM TWO**

14'5<21'1 x 11'7 (4.39m<6.43m x 3.53m)

Double glazed bay window to front, coved ceiling, range of fitted wardrobes, radiator, power points, carpet.

## **BEDROOM THREE**

14'2 max x 12' (4.32m max x 3.66m)

Double glazed half bay window to front, coved ceiling, range of fitted wardrobes with matching chest of drawer and dressing units, radiator, power points, carpet.

## **BATHROOM**

Opaque double glazed windows to rear and side, coved ceiling, built-in airing cupboard, suite comprising bath with mixer tap and shower attachment, pedestal wash hand basin and low flush toilet, radiator, tiled walls, vinyl flooring.







### REAR GARDEN

in excess of 110' (in excess of 33.53m)

Immediate patio area, lawn area with mature shrubs and conifers, remainder in need of attention, side access leads to:

### FRONT GARDEN

Crazy paved providing off road parking for two/three vehicles.

### COUNCIL TAX

Band F





















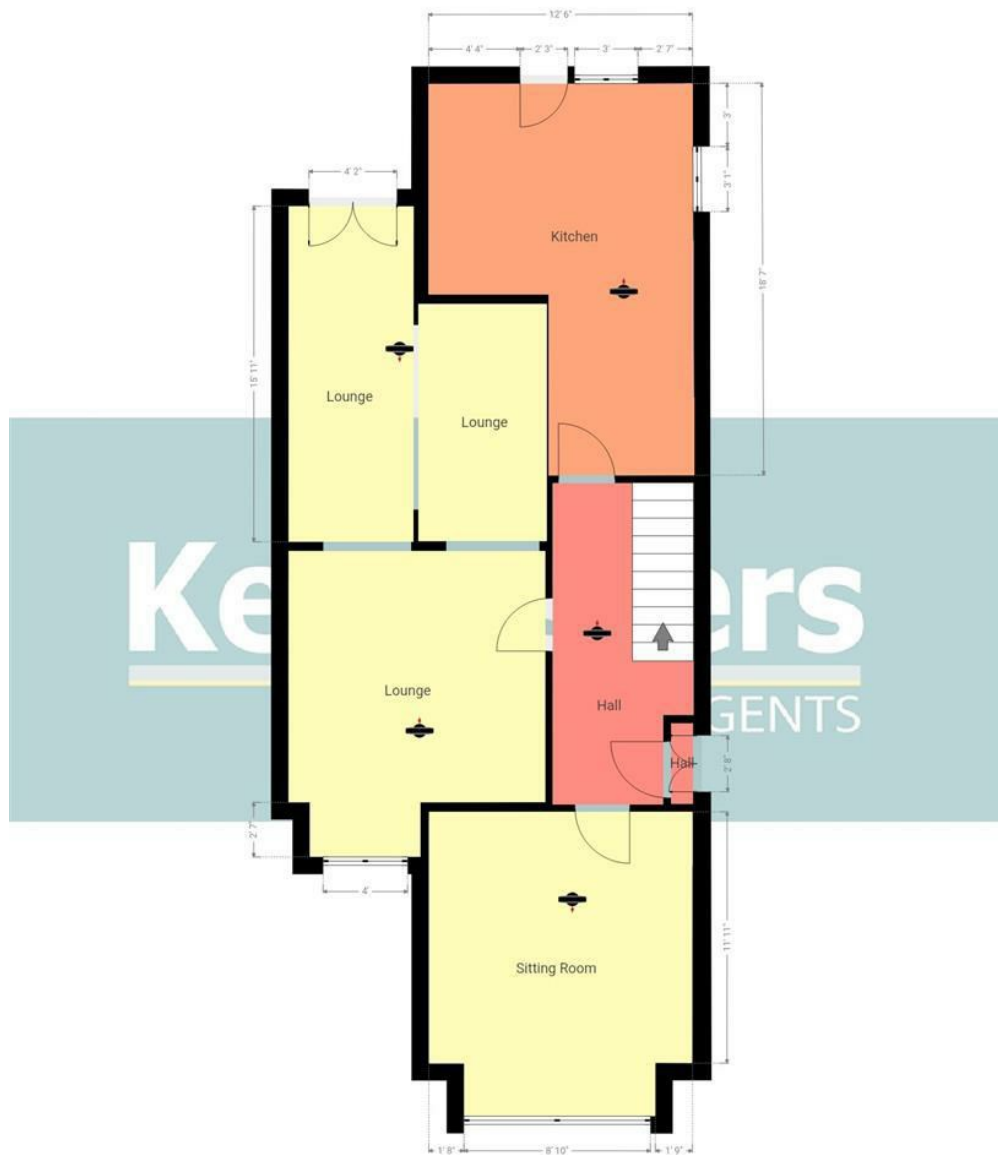

Kempsters Estate Agents take no responsibility for any error, omission, misstatement or use of data shown. This plan is for illustrative purposes only and whilst every attempt has been made to ensure the accuracy of the floorplan shown, all measurements, positioning, fixtures, fittings and any other data shown are an approximate interpretation for illustrative purposes only. These plans are the property of Kempsters Estate Agents Ltd and must not be reproduced in any form without our permission.

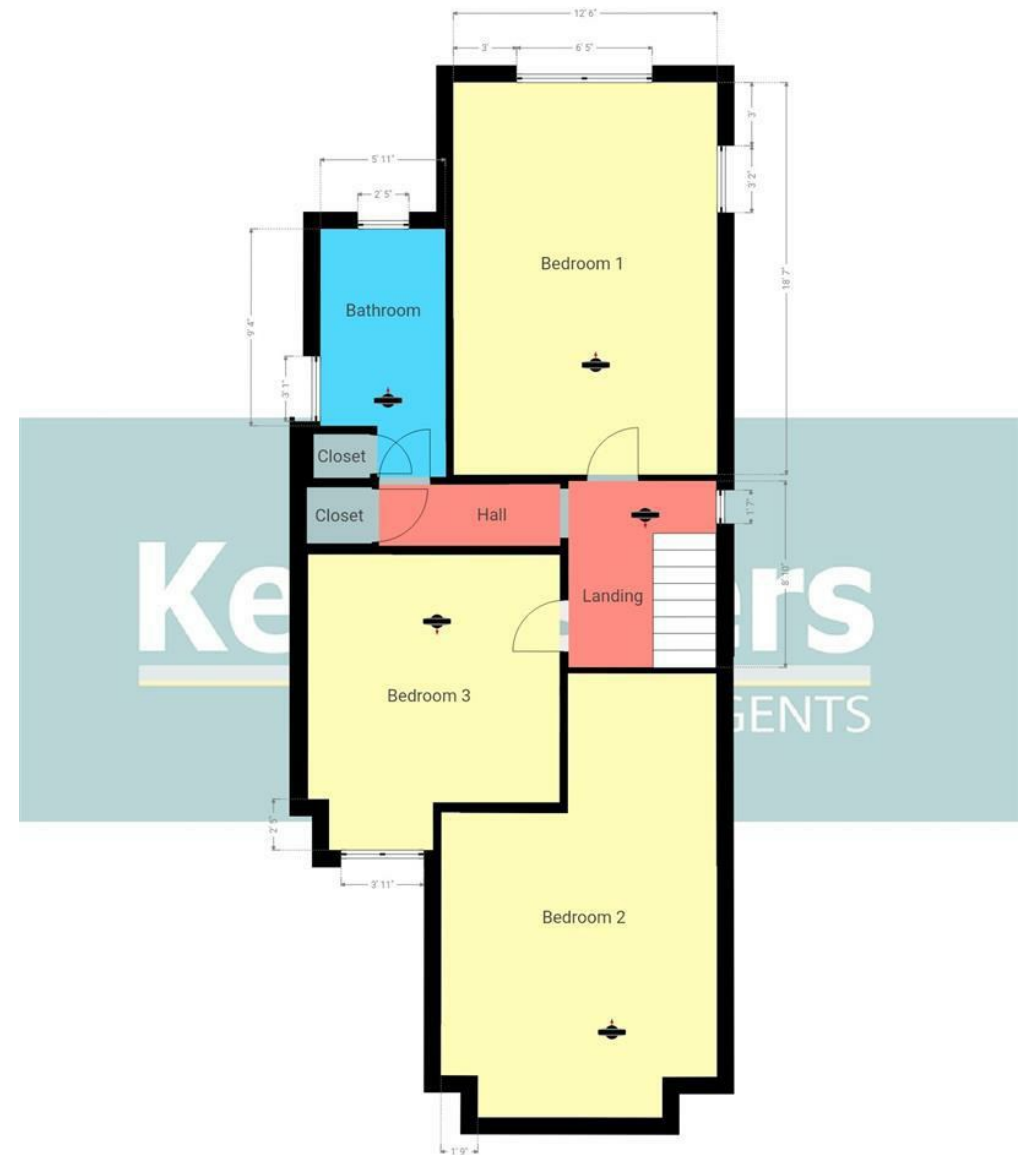

Kempsters Estate Agents take no responsibility for any error, omission, misstatement or use of data shown. This plan is for illustrative purposes only and whilst every attempt has been made to ensure the accuracy of the floorplan shown, all measurements, positioning, fixtures, fittings and any other data shown are an approximate interpretation for illustrative purposes only. These plans are the property of Kempsters Estate Agents Ltd and must not be reproduced in any form without our permission.

Disclaimer: This brochure is for illustrative purposes only and, whilst every attempt has been made to ensure accuracy, Kempsters Estate Agents Ltd take no responsibility for any error, omission, mis-statement or use of any of the information shown. No appliances or main services have been checked.

37 Orsett Road Grays, Essex RM17 5DS • Tel: 01375 394 732 • Email: [sales@kempsters.com](mailto:sales@kempsters.com)

